

Permit

The Environmental Permitting (England & Wales) Regulations 2010

GB Railfreight Limited

Upside Railway Yard
Brent Terrace
Cricklewood
London
NW2 1LN

Permit number
EPR/AB3200KE

Permit

Permit number

EPR/AB3200KE

The Environment Agency hereby authorises, under regulation 13 of the Environmental Permitting (England and Wales) Regulations 2010

GB Railfreight Limited (“the operator”),

whose registered office is

15-25 Artillery Lane

London

E1 7HA

company registration number 03707899.

to operate *waste operations* described in standard rules SR2009No5 at

Upside Railway Yard

Brent Terrace

Cricklewood

London

NW2 1LN

to the extent authorised by and subject to the conditions of this permit.

Under regulation 27(2) of the Regulations, standard rules SR2009No5 are conditions of this permit.

Name	Date
Emma Preston	28/08/2013

Authorised on behalf of the Environment Agency

Schedule 1 - Site plan

This is the plan referred to in the standard rules SR2009No5

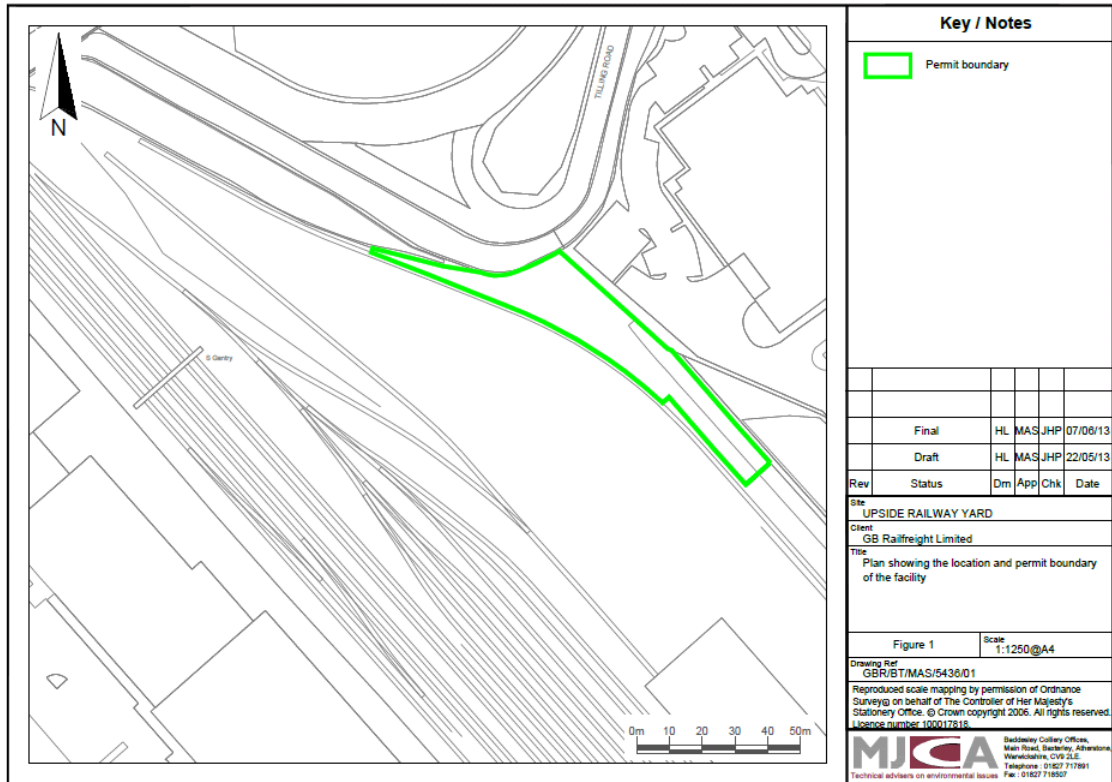

Key / Notes

Permit boundary

Rev	Status	Dm	App	Chk	Date
	Final	HL	MAS	JHP	07/06/13
	Draft	HL	MAS	JHP	22/05/13

Site: UPSIDE RAILWAY YARD
 Client: GB Railfreight Limited

Title: Plan showing the location and permit boundary of the facility

Figure 1 Scale 1:1250@A4

Drawing Ref: GBR/ST/MAS/5438/01
 Reproduced scale mapping by permission of Ordnance Survey on behalf of The Controller of Her Majesty's Stationery Office. © Crown copyright 2006. All rights reserved.
 Licence number: 100017318

MJCA Stationery Colliery Offices,
 Main Road, Buxley, Alfreton,
 Walsby, CV9 2LE
 Telephone: 01527 717891
 Fax: 01527 718507
 Technical advisers on environmental issues